

# MASSIFICATION

## VILLENEUVE LE ROI

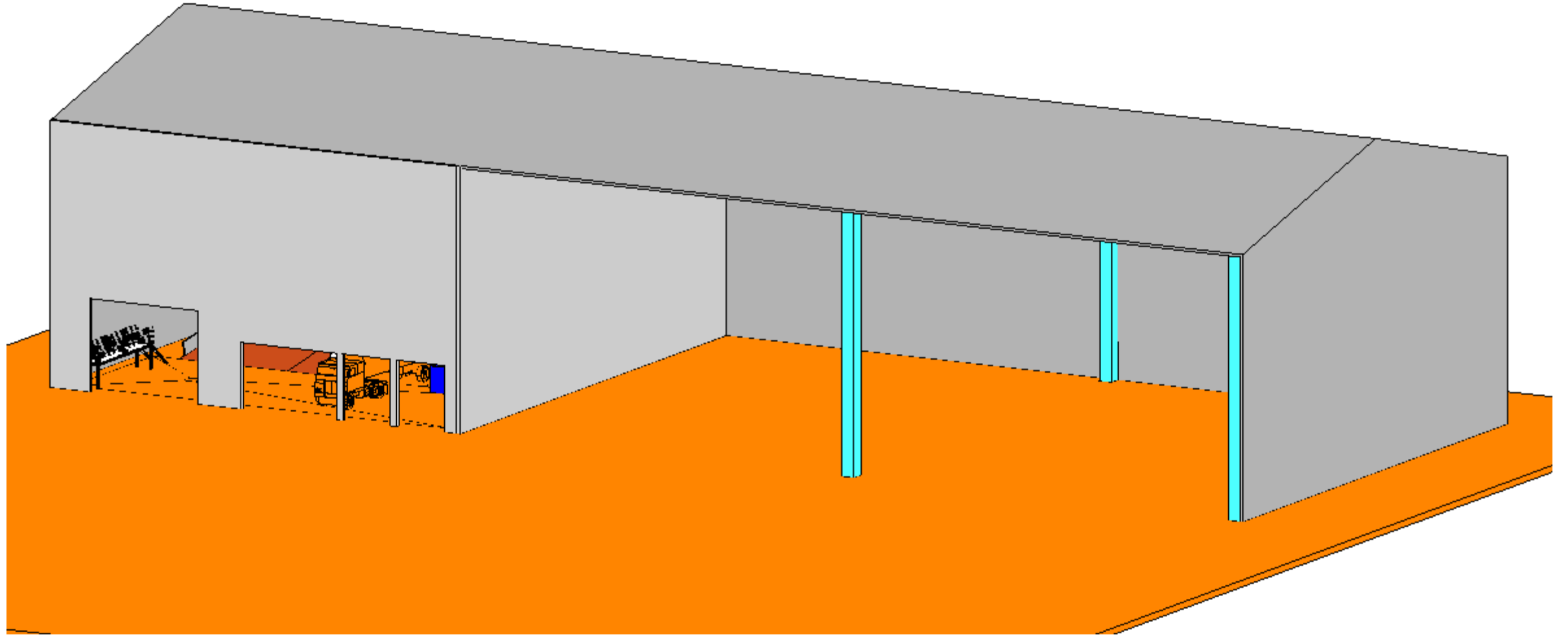

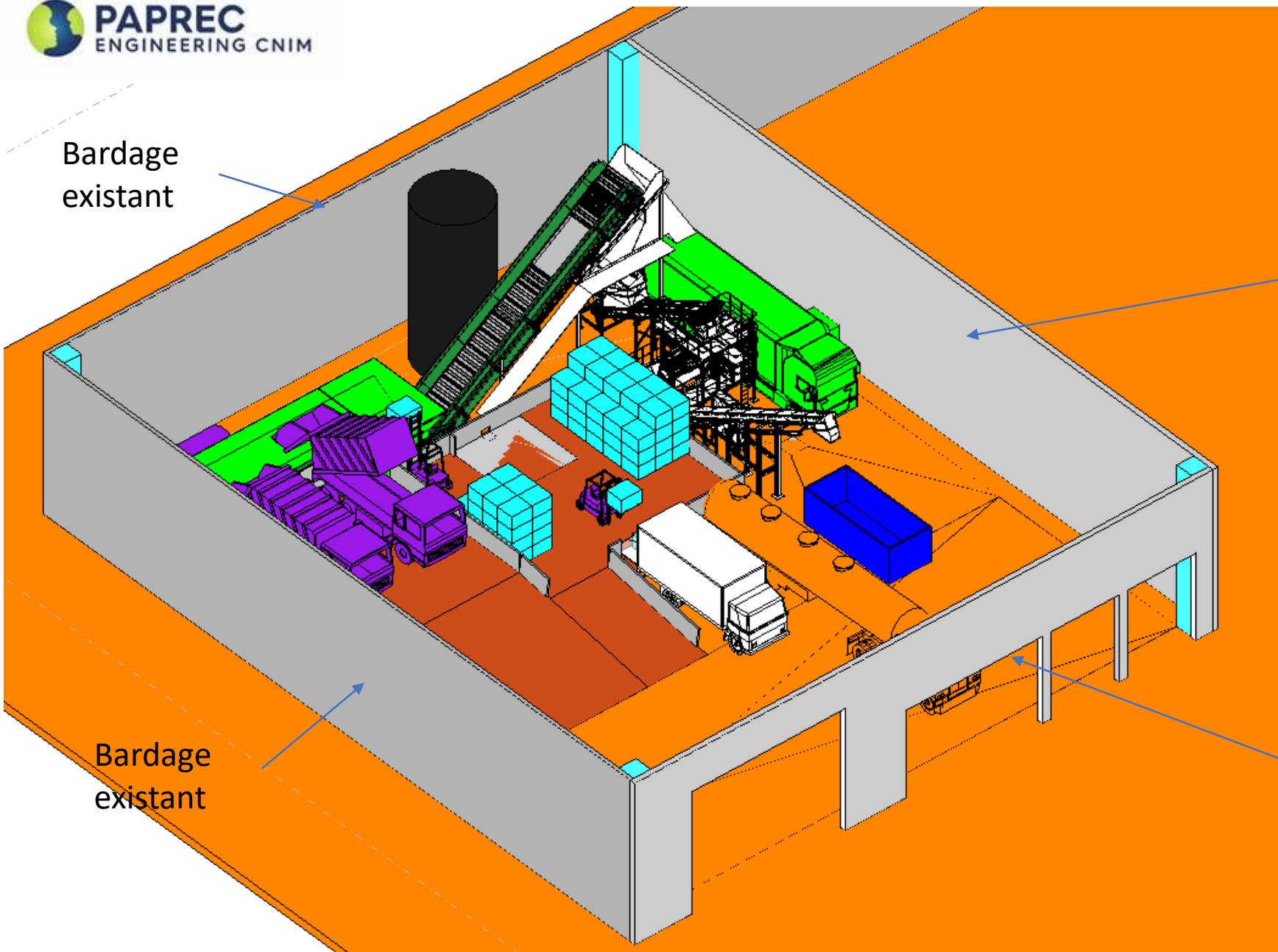

Volume bâtiment environ 30000m3

Bardage existant

Bardage a ajouter  
(environ 900m<sup>2</sup>)

Bardage existant

Bardage a ajouter  
(540m<sup>2</sup> porte déduites)

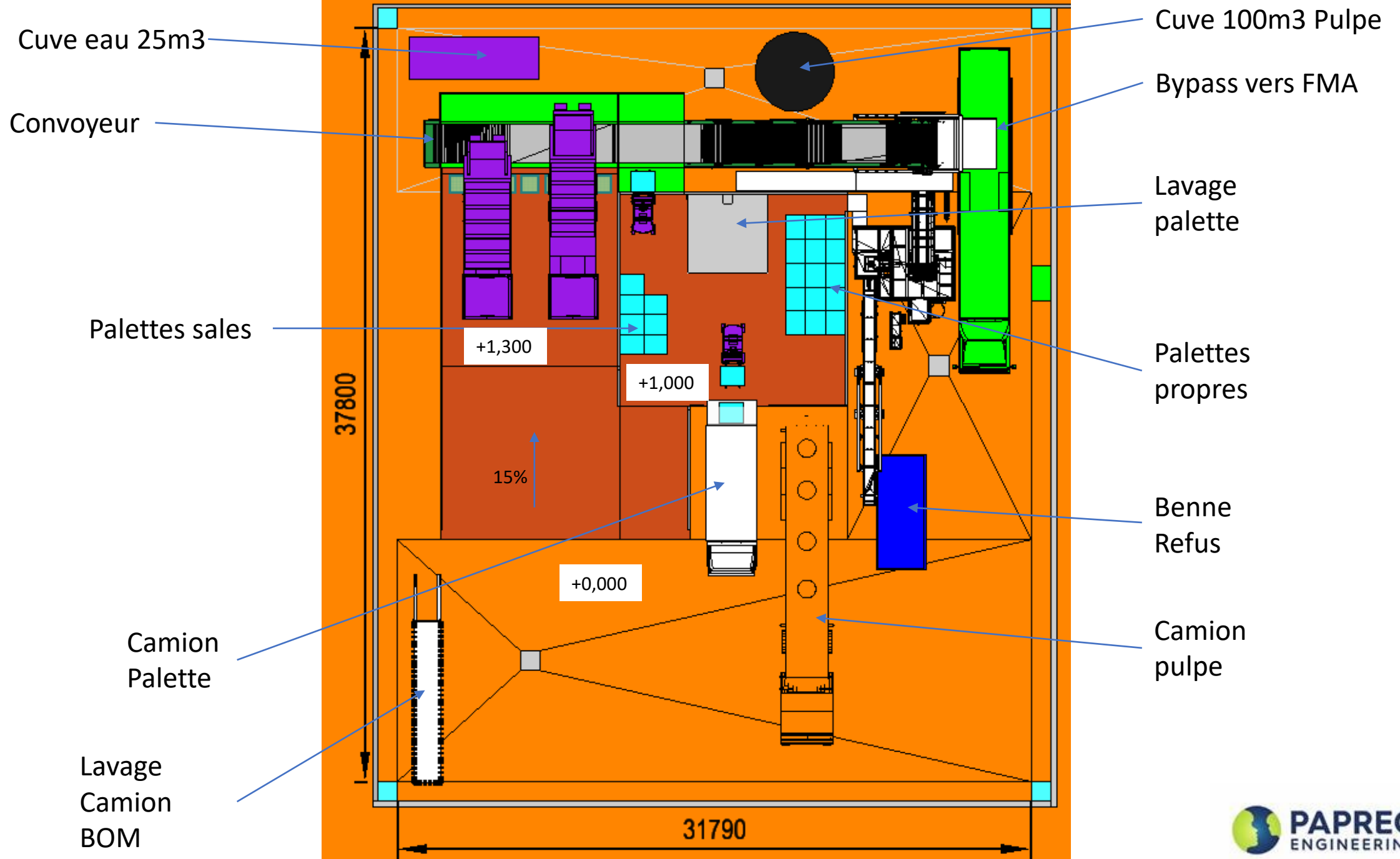

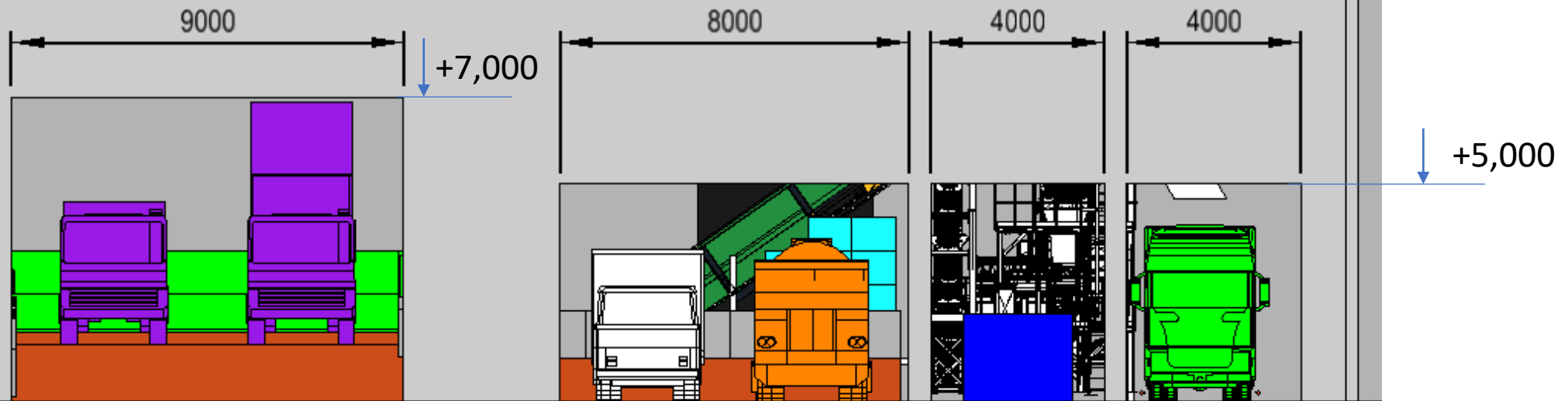

25880

2820

Depotage  
camion BOM

Depotage  
Caisse palette

9475

35.0°

Decoditionneur

Bypass

3085

1200

